

LOT
19

GLENWOOD
— HOMES —



AVALON Bolivia, NC

The BRUNSWICK

LOT
19



3 BR 2 BA

1,858 HEATED SQ. FT.

1308 N. Fisher King Drive SE • Bolivia, NC 28422
Avalon of the Carolinas • Listed at \$338,257



EXTERIOR FINISHES

3
Bedrooms

2
Baths

1,858
Heated Sq. ft.



Black



Moire Black



White

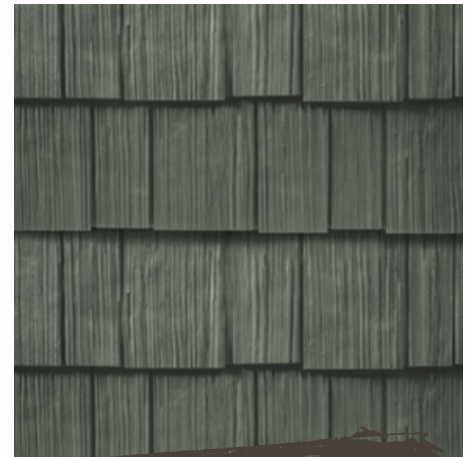

Scottish Thistle

DOOR:
SW 7020 Black Fox

For Illustrative Purposes Only

LOT 19
1308 N. Fisher King Drive SE • Bolivia, NC 28422



3
Bedrooms

2
Baths

1,858
Heated Sq. ft.



For Illustrative Purposes Only



3
Bedrooms

2
Baths

1,858
Heated Sq. ft.

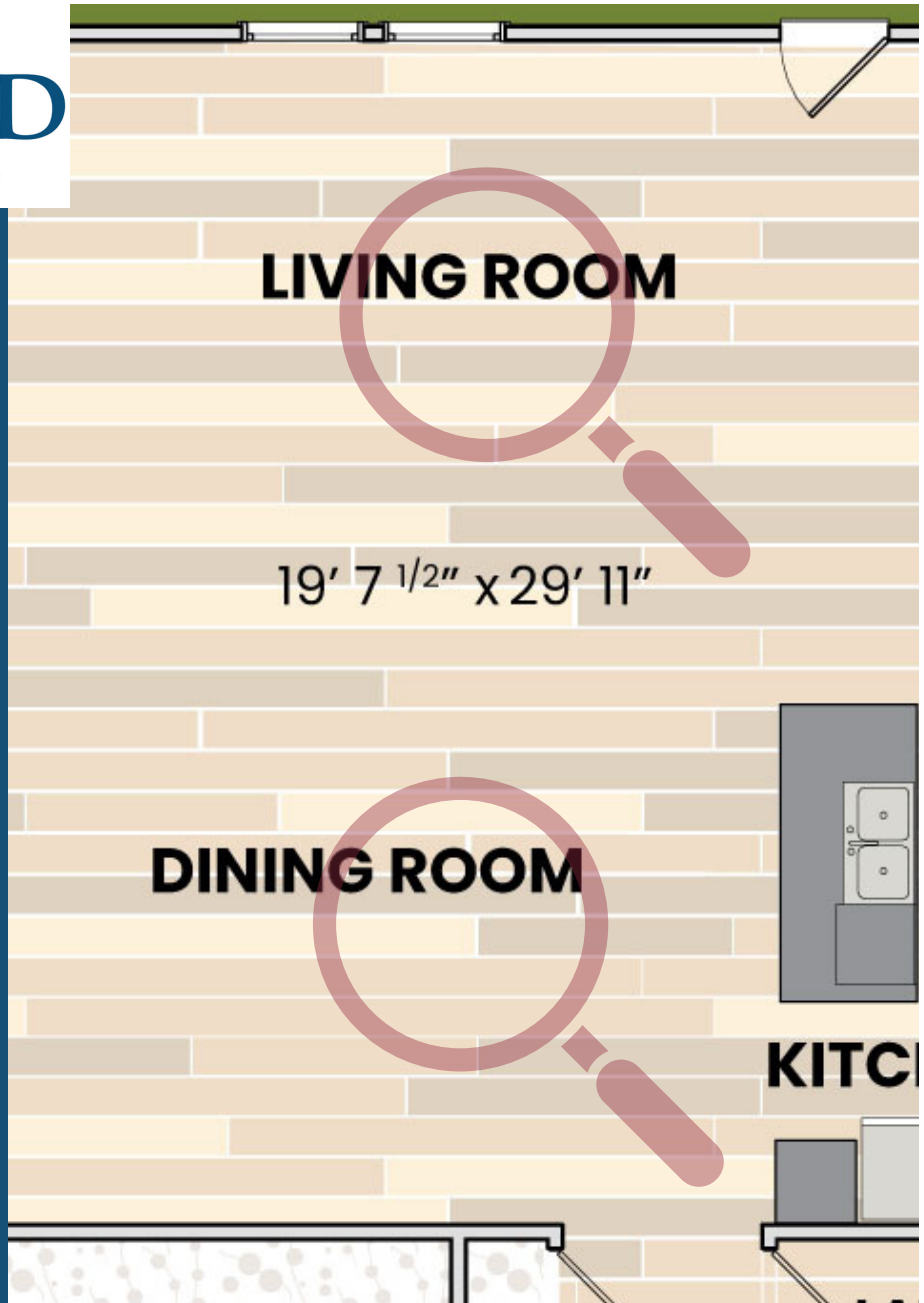

SW 7646
FIRST STAR

Luxury Vinyl Plank
Simply Écru

For Illustrative Purposes Only



3
Bedrooms

2
Baths

1,858
Heated Sq. ft.

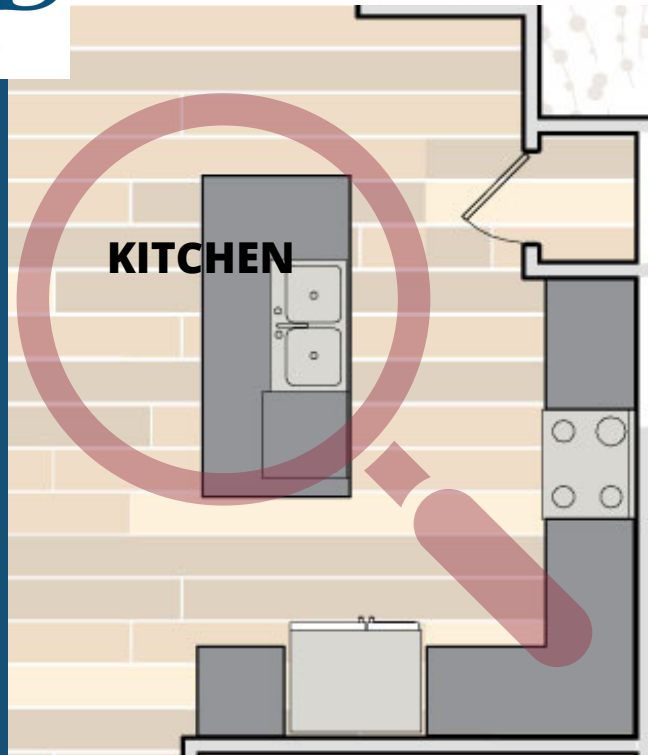

**Jolie
Brushed
Nickel**



**Moen
Arbor**

**Backsplash
Vitruvian White
Gloss**



**Cabinets
Wolf
Sierra
White**

**Brushed
Nickel**



**Granite Counters
Luna Pearl**

For Illustrative Purposes Only

3
Bedrooms

2
Baths

1,858
Heated Sq. ft.

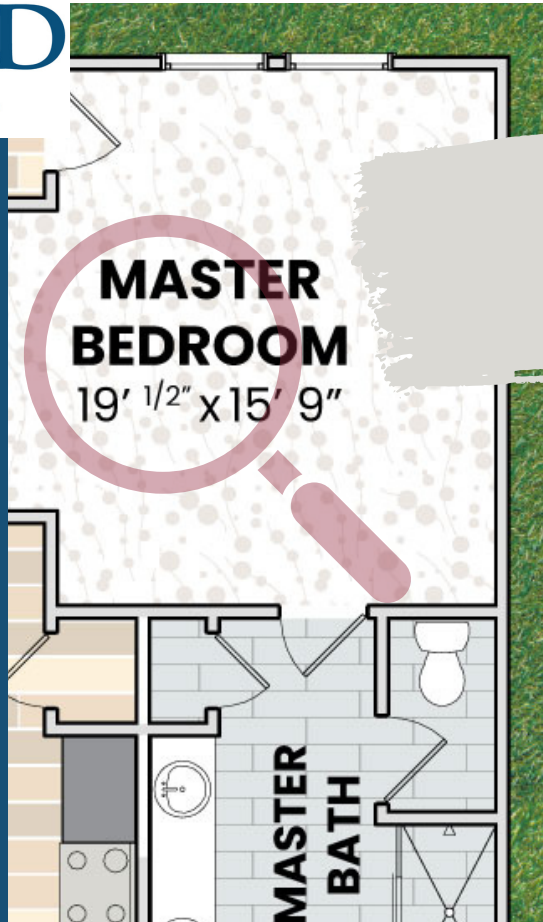

SW 7646
FIRST STAR



Mohawk Carpet
Quiet Beige

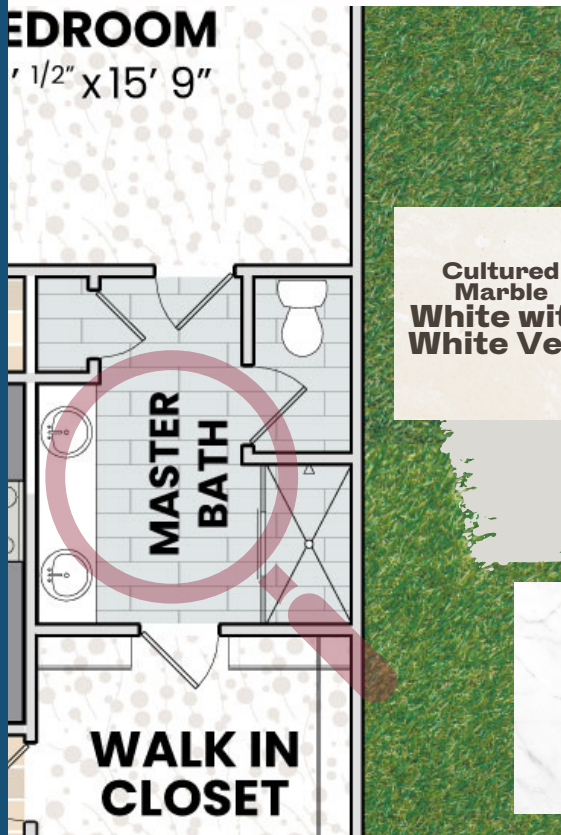

Cultured
Marble
White with
White Vein



Jolie
Brushed
Nickel

SW 7646
FIRST STAR

Tile
Costar 12x12
Calacatta Empire,

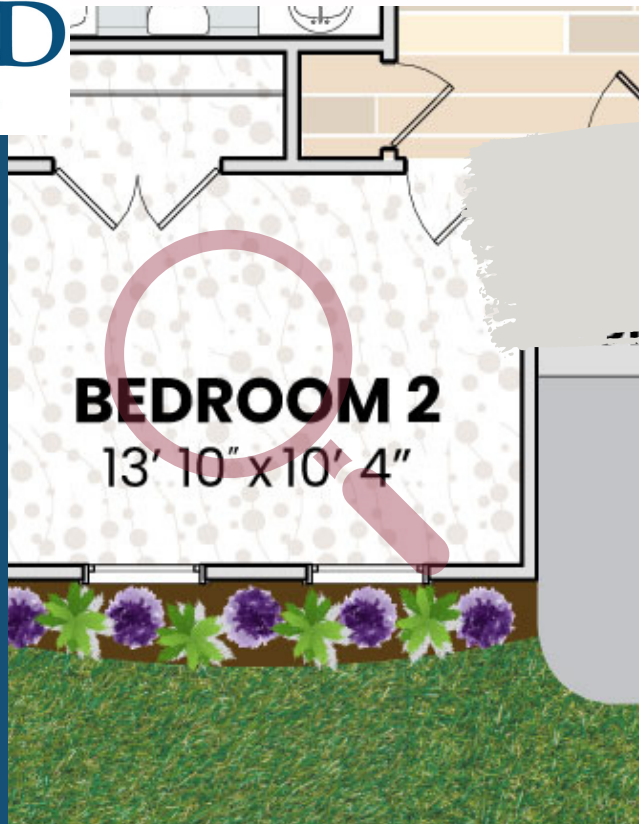

**SW 7646
FIRST STAR**



**Mohawk Carpet
Quiet Beige**

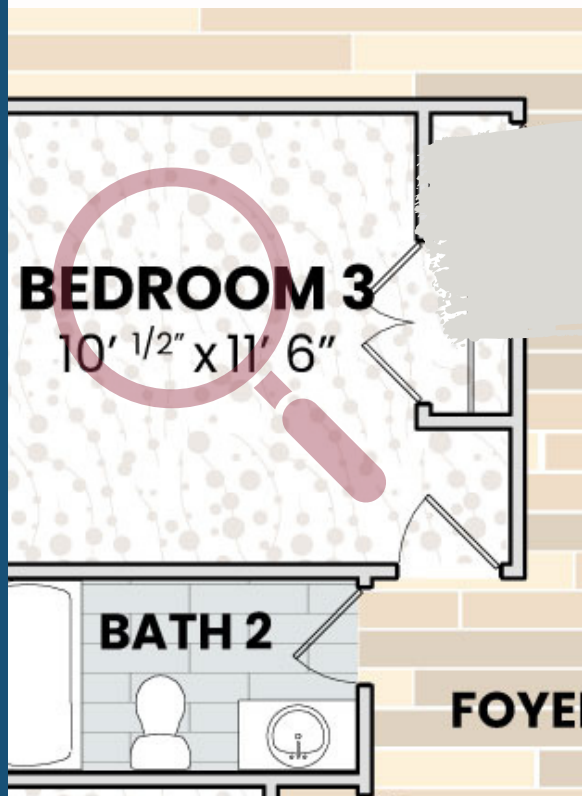

**SW 7646
FIRST STAR**



**Mohawk Carpet
Quiet Beige**

3
Bedrooms

2
Baths

1,858
Heated Sq. ft.

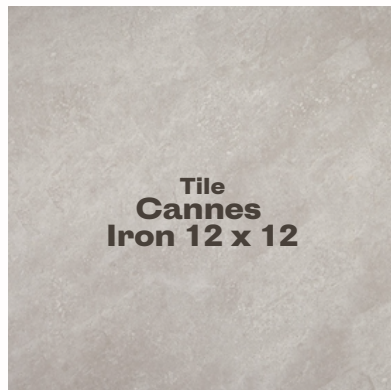
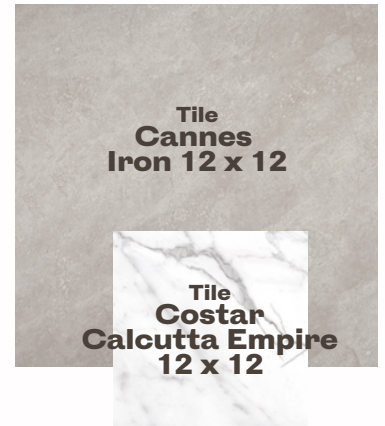
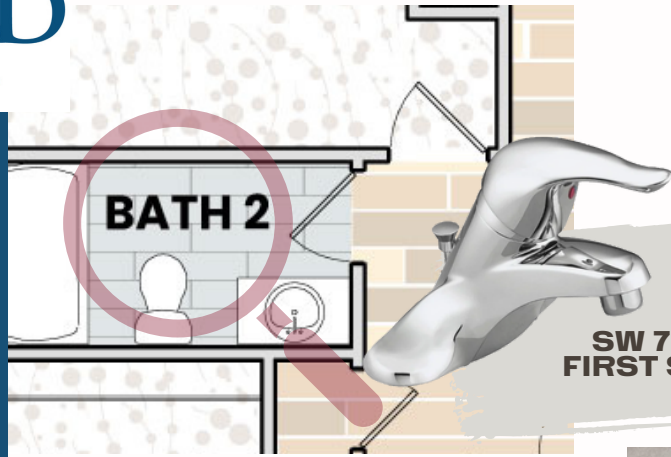

3
Bedrooms

2
Baths

1,858
Heated Sq. ft.



Avalon Standard Features

INTERIOR FEATURES

Luxury Vinyl Plank flooring throughout 1st floor
Tile flooring in owner's bathroom
No-wax resilient flooring in laundry and secondary bathrooms
Mohawk Carpet in Loft, Stairs and all Bedrooms with 5 lb pad
Powder room with pedestal sinks
9' smooth ceilings on 1st floor
Brushed nickel door handles and hardware
Designer brushed nickel lighting package
50 Gal. Electric Water Heater
Elegant 2-panel bead board arched interior doors
3/4" baseboard
Smoke detectors per code
Ceiling Fan pre-wire in Family room
Master bedroom
2 Phone Outlet /2 Cable Outlets
Zoned HVAC System per plan
Washer and Dryer electric connections
Ice maker refrigerator connection
Sherwin Williams/Duron paints

KITCHEN FEATURES

Recessed lighting per plan
Frigidaire Appliances Stainless Steel
Smooth top, Self-Cleaning Range
Microwave
Dishwasher
1/3 hp Garbage Disposal
Stainless Steel double-bowl sink
36" /42" Staggered Flat Panel Birch Cabinetry with crown molding
Level 1 Granite countertops in kitchen
Kitchen Pantry per plan

BATH FEATURES

Cultured marble vanity tops in bathrooms
Ventilated closet shelving in bedrooms and Kitchen Pantry
Chrome Moen plumbing fixtures/towel bars
Master bath with 5' Fiberglass Shower with optional shower door
Contemporary chrome towel and toilet paper bars
Brushed chrome lighting fixtures
Raised 35" height vanity in all baths

ECO-FRIENDLY AND ENERGY SAVINGS

50 Gallon electric water heater
"Fuel-saver" insulation package
R15 in walls
R19 in overhangs
R38 in attic
Efficient 14-SEER central A/C with smart thermostat
"Low-E" vinyl tilt single hung double-paned windows with 1/2 screens
Exterior OSB sheathing with House wrap
LP OSB Tech Shield Roof sheathing
Ridge vent and attic ventilation system
Insulated Fiberglass Main Entry Door

EXTERIOR FEATURES

30-year CertainTeed Architectural roofing
Raised Panel Style Garage Doors
Fully Sheet Rocked Garage
Garage Door Opener
Coach Lights at Garage Door
Professional landscaping
Fully Sodded front yards and 20' back from rear of main house corners Bermuda sod
10 x 8 Concrete Patio
5" Rain Gutters
Two exterior all weather electric outlets (Front and rear)
Two exterior hose bibs (Front and rear)
Exterior lights at front and rear patios
Brushed nickel front door entry
Minimal maintenance exterior material
Sherwin Williams/Duron paints
Raised Stem Wall Slab Foundations

GLENWOOD HOMES QUALITY ASSURANCE

Pre-construction orientation
Pre-drywall frame walk
Management quality inspection
Pre-settlement customer orientation

CUSTOMIZABLE UPGRADES AVAILABLE

Contact a Sales Representative for complete details.

Subject to change without notification.



Contact:

Jessica Wainwright

Glenwood Homes Coastal Representative

jess@jesswain.com / 910-524-3463 mobile

